

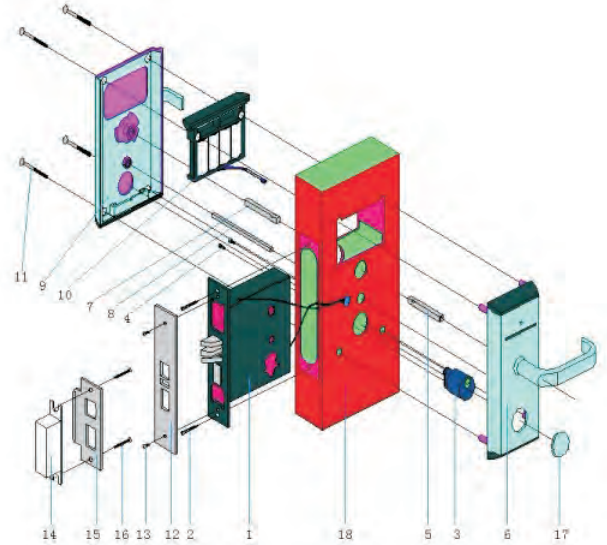

Features:

- Zink Alloy with Solidity Nature
- Free Handle to Prevent External Stress
- Mechanical Key Supported
- 256 Record of Door Opening
- Application: Hotel, Parking Lot, Residence
- Community, Office Entrance Guard



1	Key cylinder (lockbody)	10	Battery box
2	screws	11	inner screws
3	Mechanical cylinder	12	Testing strip
4	Inner screws (cylinder)	13	screws
5	big shaft	14	Buckle plastic box
6	Front panel	15	Lock buckle
7	Big shaft	16	screws
8	Long shaft	17	Lock cylinder lid
9	Back panel	18	door

Specification

S-HL20

Card Type	ID,TEMIC,MF1
Inductive distance	5cm
Power Supply	DC 6V 4pc of No.5 Alkaline Batteries
Power Consumption	Static Current: 15 μ A
Card Reading Current	20 mA
Lock Opening Current	About 300 mA (last for 0.3s)
Temperature	-20°C~+70°C
Humidity	95% RH
Lack of Voltage Indication	When the voltage is < 4.8V, there will be a 3 sound and the red LED will light. Furthermore, the lock can still be opened for more than 50 times.
Application	Hotels, Parking Lot, Residence Community, Office Entrance Guard and so on
Specialities	Output Guard, Water Proof And Moisture Proof, Tamper-proof Management. Anti-static electricity: >15,000 V, it ensures information inside the lock not missing under the interference of strong static electricity.

Hotel Lock

Intelligent Hotel Lock Management System

